

PROJECT
 ADDITION AND ALTERATION OF
 STATESMAN HOUSE
 AT PREMISES NO. 4, CHORRINGHEE SQUARE
 KOLKATA-700001

TITLE
 SECOND FLOOR PLAN &
 PARKING PLAN AT 11.75 M. LEVEL

DRG. NO.	S389/COMP/V-07	DATE	12.11.2019
SCALE	1:100	DESIGNED BY	CHD/ST
JOB NO.	DM/5586	APPROVED BY	DM
ISSUE STATUS		CORPORATION	

TYPE	WIDTH	HEIGHT	REMARKS
W	4000	2400	
W1	3400	2100	
W2	1800	2100	GLAZED WINDOW
W3	1500	2100	GLAZED WINDOW
W4	1500	2100	GLAZED WINDOW
W5	1000	2100	
W6	1000	2100	
W7	1000	2100	
W8	1000	2100	
W9	1000	2100	
W10	1000	2100	
W11	1000	2100	
W12	1000	2100	
W13	1000	2100	
W14	1000	2100	
W15	1000	2100	
W16	1000	2100	
W17	1000	2100	
W18	1000	2100	
W19	1000	2100	
W20	1000	2100	
W21	1000	2100	
W22	1000	2100	
W23	1000	2100	
W24	1000	2100	
W25	1000	2100	
W26	1000	2100	
W27	1000	2100	
W28	1000	2100	
W29	1000	2100	
W30	1000	2100	
W31	1000	2100	
W32	1000	2100	
W33	1000	2100	
W34	1000	2100	
W35	1000	2100	
W36	1000	2100	
W37	1000	2100	
W38	1000	2100	
W39	1000	2100	
W40	1000	2100	
W41	1000	2100	
W42	1000	2100	
W43	1000	2100	
W44	1000	2100	
W45	1000	2100	
W46	1000	2100	
W47	1000	2100	
W48	1000	2100	
W49	1000	2100	
W50	1000	2100	
W51	1000	2100	
W52	1000	2100	
W53	1000	2100	
W54	1000	2100	
W55	1000	2100	
W56	1000	2100	
W57	1000	2100	
W58	1000	2100	
W59	1000	2100	
W60	1000	2100	
W61	1000	2100	
W62	1000	2100	
W63	1000	2100	
W64	1000	2100	
W65	1000	2100	
W66	1000	2100	
W67	1000	2100	
W68	1000	2100	
W69	1000	2100	
W70	1000	2100	
W71	1000	2100	
W72	1000	2100	
W73	1000	2100	
W74	1000	2100	
W75	1000	2100	
W76	1000	2100	
W77	1000	2100	
W78	1000	2100	
W79	1000	2100	
W80	1000	2100	
W81	1000	2100	
W82	1000	2100	
W83	1000	2100	
W84	1000	2100	
W85	1000	2100	
W86	1000	2100	
W87	1000	2100	
W88	1000	2100	
W89	1000	2100	
W90	1000	2100	
W91	1000	2100	
W92	1000	2100	
W93	1000	2100	
W94	1000	2100	
W95	1000	2100	
W96	1000	2100	
W97	1000	2100	
W98	1000	2100	
W99	1000	2100	
W100	1000	2100	

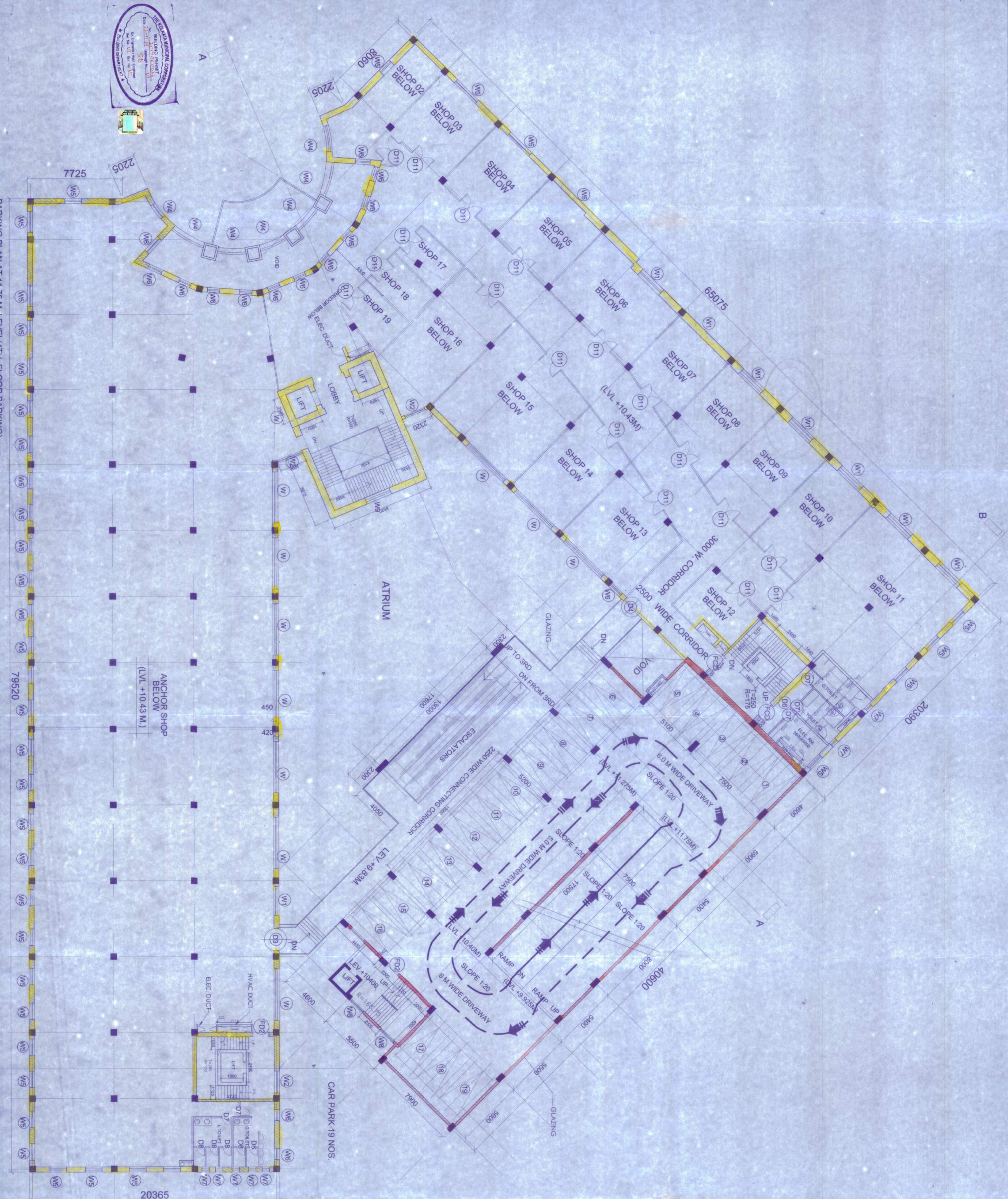

PARKING PLAN AT 11.75 M. LEVEL (4TH FLOOR PARKING)
 Scale 1:100



NOTE
 1) ALL DIMENSIONS ARE IN METERS UNLESS OTHERWISE STATED.
 2) ALL DIMENSIONS SHALL BE TO FACE UNLESS OTHERWISE STATED.
 3) ALL DIMENSIONS SHALL BE TO FACE UNLESS OTHERWISE STATED.
 4) ALL DIMENSIONS SHALL BE TO FACE UNLESS OTHERWISE STATED.
 5) ALL DIMENSIONS SHALL BE TO FACE UNLESS OTHERWISE STATED.

STRUCTURAL ENGINEER
M.N. CONSULTANT PVT. LTD.
 13/21, DASHRATH NAGAR, KOLKATA, 700019

ARCHITECT
DUAL MUKHERJEE & ASSOCIATES
 22 B SHAKHBADEE, SEWAK, CALCUTTA 700017

DATE: 12.11.2019
 SCALE: 1:100
 PROJECT: ADDITION AND ALTERATION OF STATESMAN HOUSE AT PREMISES NO. 4, CHORRINGHEE SQUARE KOLKATA-700001

CERTIFIED COPY

Before starting any construction the site must be cleared of all obstructions as proposed in the plan and all foundations as proposed in the plan should be verified.

To execute the work is subject to the above conditions.

No man water pipe should be fixed or disconnected from the main sewer line.

Design of all structural members should conform to standards specified in the National Building Code of India.

A water-proof tank to be provided for the building within five years of the completion of the work.

All building materials to be used shall be of standard quality and shall conform to standards specified in the National Building Code of India.

THE SANCTION IS VALID UP TO 31-12-2024

After commencement of execution of the work, the contractor shall submit monthly progress reports to the Engineer-in-Charge.

APPROVED FOR THE SANCTION OF M.C. UNDER THE SANCTION OF THE BUILDING COMMITTEE

Notwithstanding to the above, the contractor shall be responsible for the safety of the work at the site during the execution.

Approved by **Dr. P. S. Bhat** of the Building Committee

Execution of the work shall be subject to the above conditions.



THE BUILDING MATERIALS THAT WILL BE USED SHALL BE OF STANDARD QUALITY AND SHALL CONFORM TO STANDARDS SPECIFIED IN THE NATIONAL BUILDING CODE OF INDIA.

CONSTRUCTION SITE SHALL BE MAINTAINED AT ALL TIMES IN A CLEAN AND SAFE CONDITION. ALL WASTE MATERIALS SHALL BE REMOVED FROM THE SITE AT THE END OF EACH DAY.

PANCAJITE BUILDING

Approved and signed by the Engineer-in-Charge, Kolkata Municipal Corporation, on 27/11/24.

CERTIFIED COPY

KOLKATA MUNICIPAL CORPORATION
CERTIFIED COPY OF B.S. PLAN
No. 160705/0936 D/24-11-24
Engineer-in-Charge: VI

Approved and signed by the Engineer-in-Charge, Kolkata Municipal Corporation, on 27/11/24.

RECEIVED
DATE 21/11/24

